

SWASH-PLATE TYPE
AXIAL PISTON PUMP

K3VLS

series

Suitable for machines and equipment
using load sensing control system
and/or electric displacement
control system.

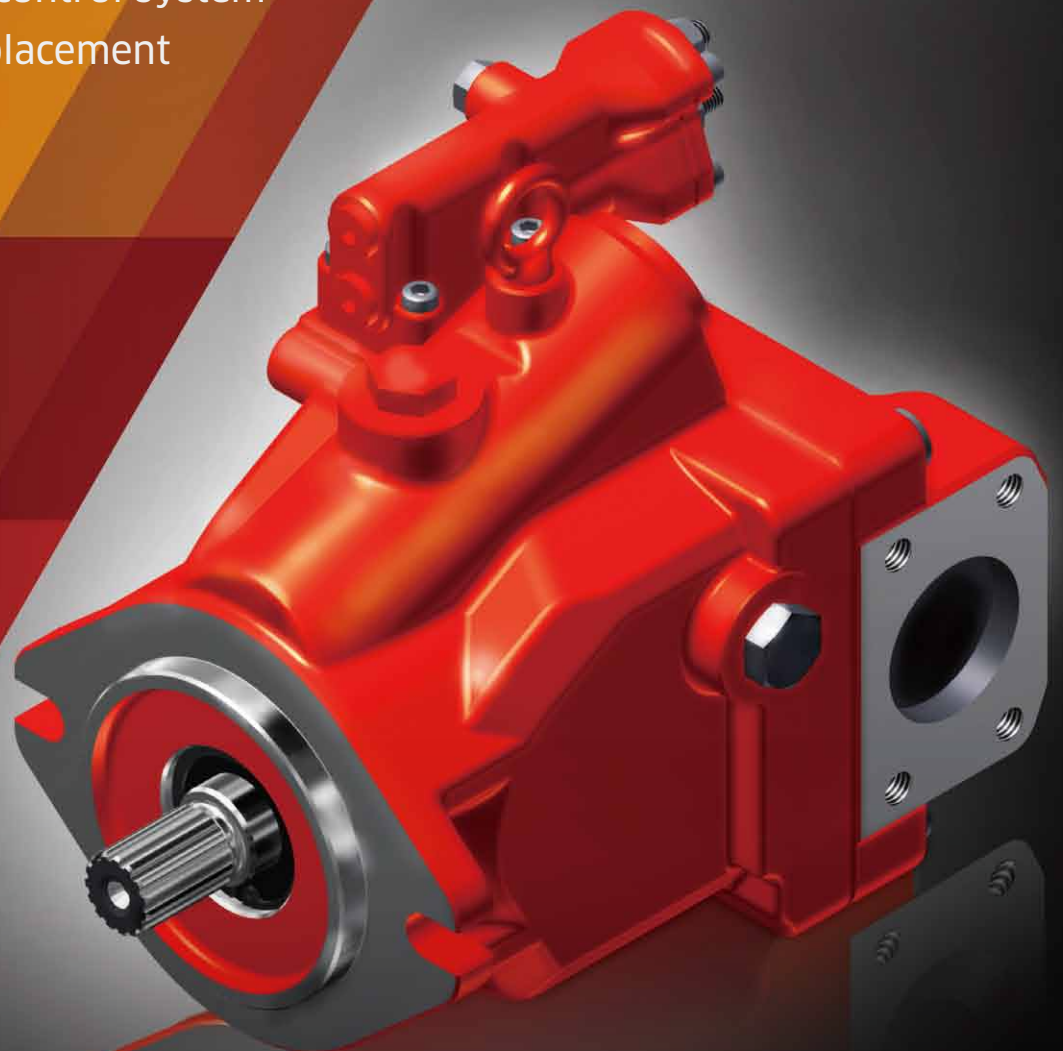

K3VLS series

ADVANTAGES

High Efficiency

Our latest technology has achieved compact and highly efficient rotary design. This contributes to the reduction of fuel consumption of the machine.

Compact and Light Weight

Compact and light weight design provides ease of installation work.

Stable and Responsive Regulator Control

Stable and responsive regulator control achieves superior machine operating performance. K3VLS series is applicable to various hydraulic systems by the load sensing control, horse power control, or electric displacement control regulators.

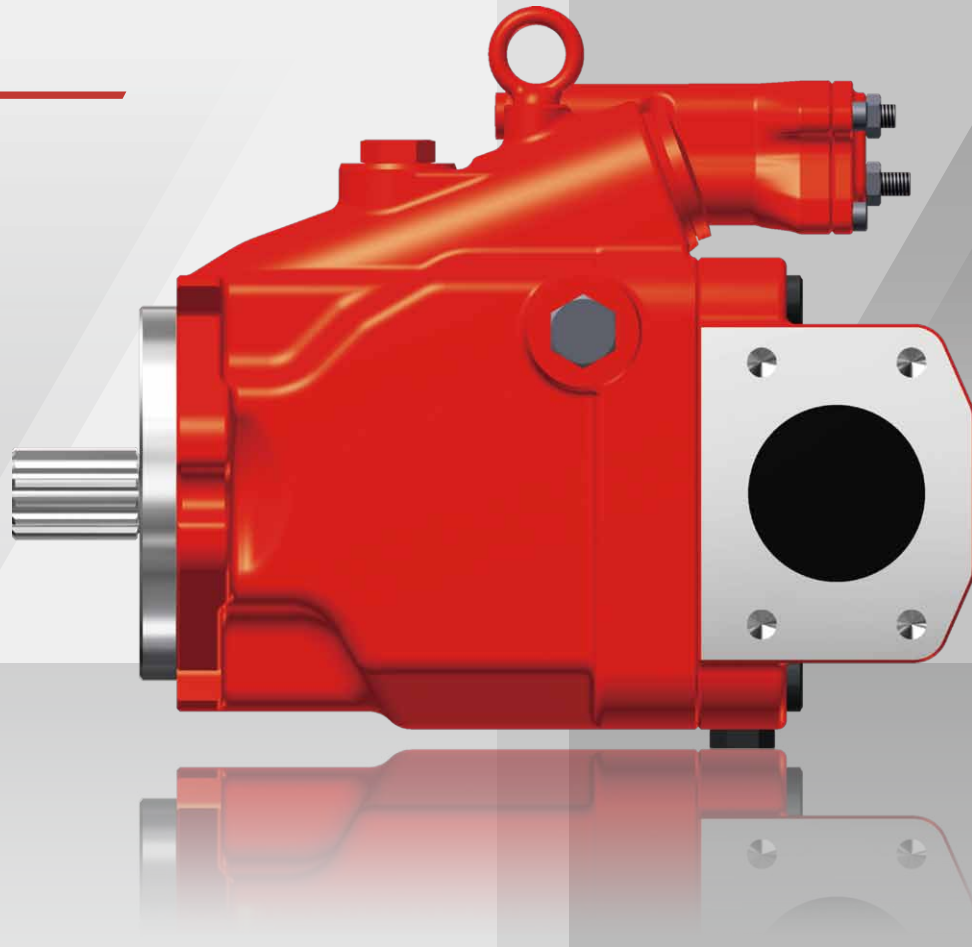

DIMENSIONS

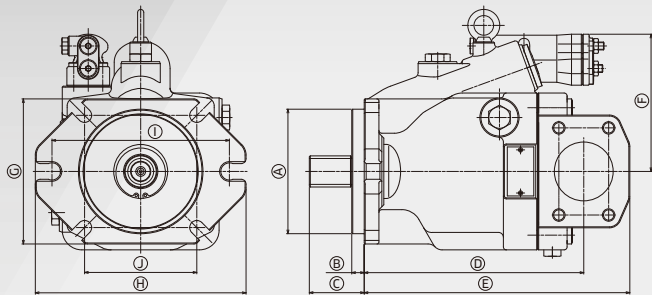

	A	B	C	D	E	F	G	H	I	J
K3VLS50 ^(*)	Φ101.6 ^{+0.05}	9.7 ^{+0.5}	46 ^{+1.4} _{-1.0}	181	214	135	124	172	146	-
K3VLS65	Φ101.6 ^{+0.05}	9.7 ^{+0.5}	46 ^{+1.4} _{-1.0}	201	239	137	136	172	146	-
K3VLS85	Φ127 ^{+0.05}	12.7 ^{+0.5}	56 ^{+1.4} _{-1.0}	224	271	140	148	215	181	□114.5
K3VLS105	Φ127 ^{+0.05}	12.7 ^{+0.5}	56 ^{+1.4} _{-1.0}	228	274	149	148	215	181	□114.5
K3VLS125 ^(*)	Φ152.4 ^{+0.05}	12.7 ^{+0.5}	75 ^{+1.4} _{-1.0}	255	301	158	□200	□200	-	□161.6
K3VLS150 ^(*)	Φ152.4 ^{+0.05}	12.7 ^{+0.5}	75 ^{+1.4} _{-1.0}	255	301	158	□200	□200	-	□161.6

(*) Under development

LINEUP

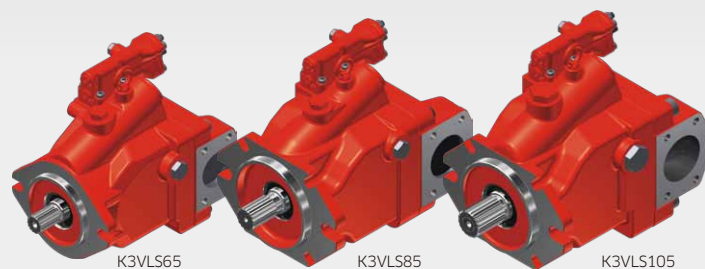

Pump Model	K3VLS50 ^(*)	K3VLS65	K3VLS85	K3VLS105	K3VLS125 ^(*)	K3VLS150 ^(*)
Displacement (cm ³)	50	65	85	105	125	150
Pressure (MPa)	Rated			28		
	Peak			35		
Max. Speed Self-priming (min ⁻¹)	2600	2600	2500	2300	2200	2200

(*) Under development

Materials and specifications are subject to change without manufacturer's obligation.

Kawasaki Heavy Industries, Ltd.
Precision Machinery Company
<http://www.khi.co.jp/kpm/>

Tokyo Head Office
1-14-5, Kaigan, Minato-ku, Tokyo 105-8315, Japan
Tel: +81-3-3435-6862 Fax: +81-3-3435-2023

Kobe Head Office
Kobe Crystal Tower, 1-3 Higashikawasaki-cho 1-chome, Chuo-ku, Kobe 650-8680, Japan
Tel: +81-78-360-8607 Fax: +81-78-360-8609

Nishi-kobe Works
234, Matsumoto, Hasetani-cho, Nishi-ku, Kobe 651-2239, Japan
Tel: +81-78-991-1160 Fax: +81-78-991-3186

Kawasaki Precision Machinery (UK) Ltd.
Ernesettle Lane, Ernesettle, Plymouth, Devon, PL5 2SA United Kingdom
Tel: +44-1752-364394 Fax: +44-1752-364816
<http://www.kpm-eu.com>

Kawasaki Precision Machinery (U.S.A.), Inc.
3838 Broadmoor Avenue S.E. Grand Rapids, Michigan 49512, U.S.A.
Tel: +1-616-975-3100 Fax: +1-616-975-3103
<http://www.kpm-usa.com>

Kawasaki Precision Machinery Trading (Shanghai) Co., Ltd.
17th Floor (Room 1701), The Headquarters Building, No168, XiZang Road (M), Huangpu District, Shanghai, 200001, China
Tel: +86-21-3366-3800 Fax: +86-21-3366-3808

Flutek, Ltd.
98 GIL 6, Gongdan-Ro, Seongsan-Ku, Changwon-Si, Kyungnam, 51567, Korea
Tel: +82-55-210-5900 Fax: +82-55-286-5557

Wipro Kawasaki Precision Machinery Private Limited
No. 15, Sy. No. 35 & 37, Kumbalgodu Industrial Area, Kumbalgodu Village, Kengeri Hobli, Bangalore, -560074, India



QR code
Precision Machinery
Company Website